



TUSCANY DOORS



Product Information

Bifold Window

19761 Bahama St, Northridge, CA 91324
(818) 818-6124



Product Overview

The Tuscany Doors Bifold Window is a perfect blend of modern design, durability, and high performance, making it an excellent choice for contemporary spaces. Engineered for superior insulation, its foam-filled profiles enhance energy efficiency and maintain a comfortable indoor environment. Built with precision, this bifold system features premium U.S.-made hardware, a secure multi-point locking mechanism, and adjustable hinges for smooth, effortless operation. Its minimalist aluminum frame, customizable glass options, and integrated inside blinds add a touch of elegance while maximizing functionality. Designed to accommodate expansive openings, this window system supports panel heights up to 8 feet and widths reaching 20 feet, providing unmatched flexibility. A low-profile bottom track ensures a seamless transition, while triple weather stripping on each panel enhances durability and protection against the elements. For those seeking a stylish, energy-efficient, and highly secure folding window system, Tuscany Doors delivers a premium solution built to last.

Energy Efficiency

Our bifold windows feature double-layer tempered glass with Low-E coating and argon gas for optimal thermal efficiency and comfort. The aluminum thermal break frame enhances insulation, reducing energy costs and maintaining consistent indoor temperatures. With a U-Factor of 0.26 and Solar Heat Gain Coefficient of 0.32, these windows maximize energy efficiency while allowing ample natural light. Designed for durability and style, they offer superior performance, enhancing comfort and energy savings. Tuscany Doors' bifold windows are the perfect solution for modern living spaces and commercial environments.

Performance Chart

ALUMINUM THERMAL BREAK FRAME	
Double layer tempered glass 5mm Low-E glass +27A argon gas+5mm clear glass	
ENERGY PERFORMANCE RATINGS	
U-Factor 0.26 (U.S./I-P)	Solar Heat Gain Coefficient 0.32
ADDITIONAL PERFORMANCE RATINGS	
Visible Transmittance 0.35	Air Leakage 0.2
Condensation Resistance 51	—

Inspection Report

No.	Inspection Item	Unit Symbol	Standard Requirement	Inspection Result	Result
1	Mg	%	0.45 - 0.9	0.46	Qualified
2	Si	%	0.20 - 0.6	0.38	Qualified
3	Fe	%	≤ 0.35	0.16	Qualified
4	Cu	%	≤ 0.10	0.03	Qualified
5	Zn	%	≤ 0.10	0.03	Qualified
6	Mn	%	≤ 0.10	0.03	Qualified
7	Cr	%	≤ 0.10	0.02	Qualified
8	Ti	%	≤ 0.10	0.03	Qualified



Finishes and Colors

Our finishes are available in standard and custom designer options, with the ability to match nearly any color. Our standard finishes include powder-coated matte black and matte white, both featuring a Class 1 coating thickness for superior smoothness and durability. Any other colors are considered custom options, featuring a high-quality paint finish that meets the AAMA-2605 rating, the highest standard for organic finishes.

Color Choice



Matte Black



Matte White



Dark Bronze



Gray



Cutsheet Highlights



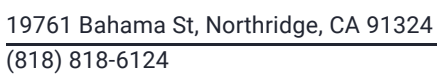

Measurements and Rough Opening

Tuscany Doors' products sizes its products from the frame to frame. The sizes on the invoice will be exact sizes of products. For rough opening requires $1/4"$ to each side (left, right and top). Installation is the sole responsibility of the home owner, distributor user contractor, or their representative.

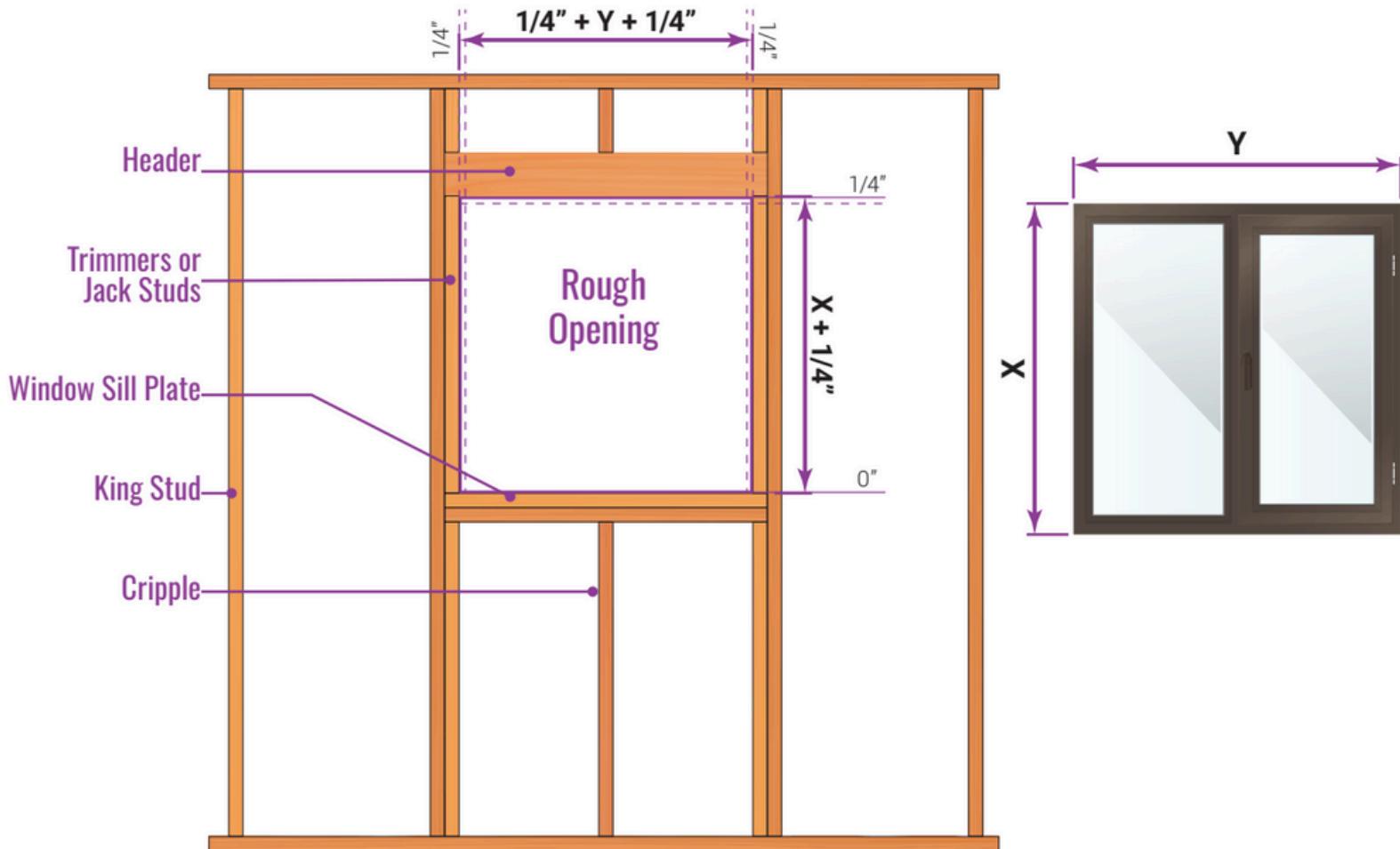

Product Accessories



Folding Wheel



Hinge



Handle



Automatic latch + Transmission box



Notes

- For rough opening size, allow a minimum 1/4" gap between the Window and rough opening.
- All dimensions are in mm and inches.
- All dimensions are to be checked on site.
- Any discrepancy between the architectural drawing and other drawings relevant for construction should be notified before commencement.
- Sill pans are required by code for doors and windows.



Tuscany Doors' aluminum products are exceptionally recyclable. In fact, aluminum is one of the most recyclable materials on the planet, capable of being recycled repeatedly without losing its quality or integrity.



TUSCANY DOORS



(818) 818-6124

sales@tuscanydoors.com



tuscanydoors.com



19761 Bahama St,
Northridge, CA 91324